

LEGEND - 1600 PUPIL

	OTHER USES		HEALTH 2 CR		ENGLISH 12 CR 1 COMP LAB 1 READING RM 1 MINI LAB		FACULTY OFFICE DEPARTMENT COLOR
	ADMIN / GUID / CONF / HEALTH		TECHNOLOGY EDUCATION 1 COMP LAB 1 CR 1 SHOP		HUMANITIES		DRAMA
	MATH 12 CR 1 COMP LAB		ART 5 STUDIOS (INCLUDING GRAPHIC ARTS) 1 COMP LAB		SPECIAL EDUCATION 1 CR 3 TUTORIALS		PHYSICAL EDUCATION
	FOREIGN LANGUAGES 12 CR 1 LANG LAB		MUSIC 1 BAND / ORCHESTRA 2 CR 1 COMP LAB		SOCIAL STUDIES 12 CR 1 COMP LAB		CORE FACILITIES / MECH / TOILETS / CUST
	SCIENCE 14 LABS PREP ROOMS OFFICE		BUSINESS 7 CR 1 COMP LAB		NEW ENCLOSED LINKS		POTENTIAL CLASSROOMS







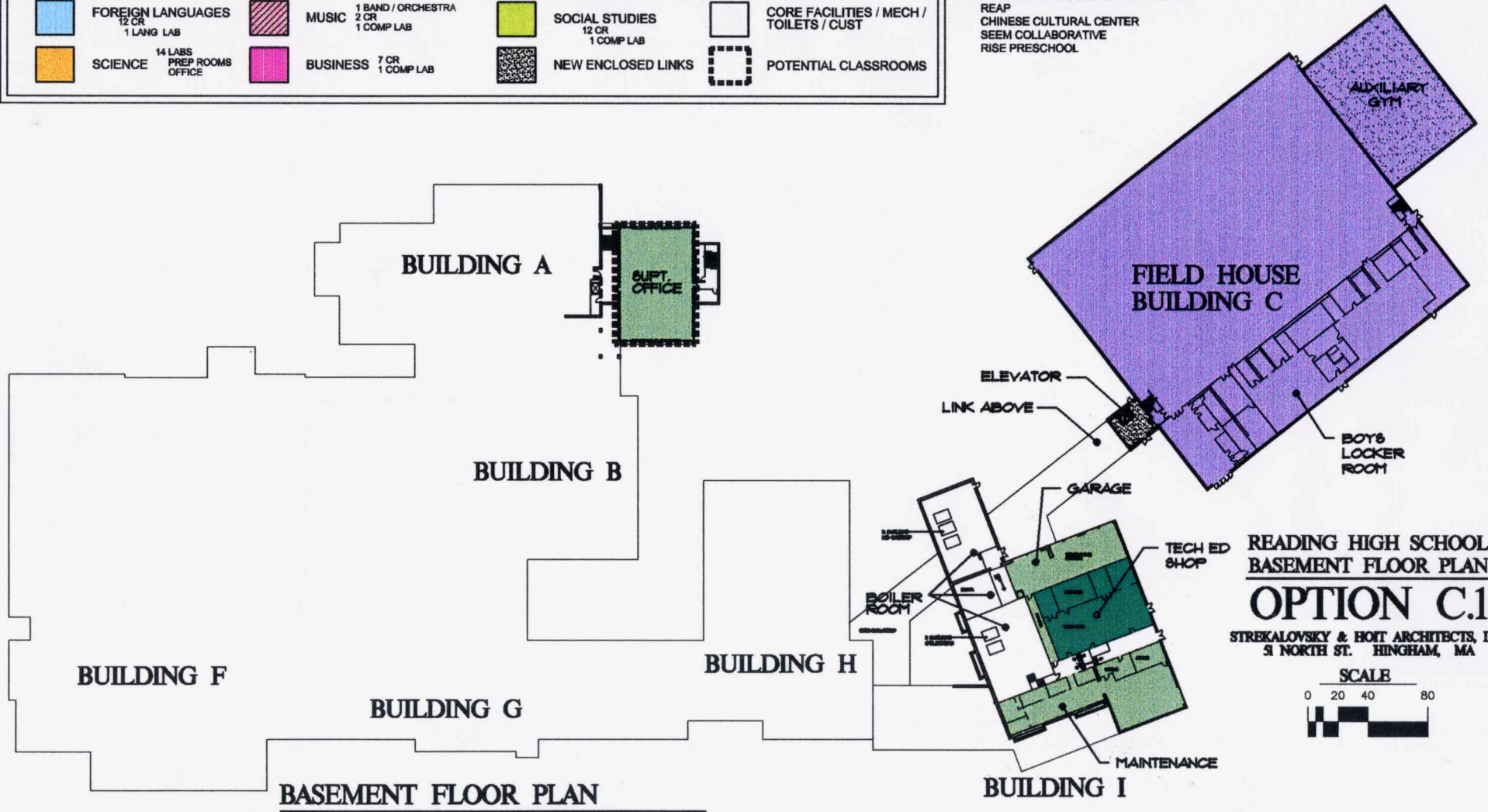









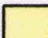

ENLARGE TEACHING STATIONS
 RELOCATE DEPARTMENTAL OFFICES TO SMALLER NON-CLASSROOM SPACES
 EACH DEPARTMENT TO SHARE CLASSROOM SPACE.
 CREATE DRAMA CENTER AT MUSIC CLASSROOM / STAGE
 CONVERT EXISTING GIRLS GYM (1950 BUILDING) TO MUSIC CENTER
 CONSTRUCT "MINI GYM" ADDITION TO FIELD HOUSE
 GIRLS LOCKER ROOM TO REMAIN IN 1950 BUILDING
 CONSTRUCT ENCLOSED ADDITION TO FIELDHOUSE

NON-HIGH SCHOOL USES TO REMAIN:
 SUPERINTENDENTS OFFICE
 DISTRICT SPECIAL NEEDS OFFICE
 DISTRICT MAINTENANCE FACILITY
 RCTV

NON-HIGH SCHOOL USES TO BE REMOVED:
 REAP
 CHINESE CULTURAL CENTER
 SEEM COLLABORATIVE
 RISE PRESCHOOL

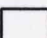

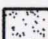
LEGEND - 1600 PUPIL

	OTHER USES		HEALTH 2 CR		ENGLISH 12 CR 1 COMP LAB 1 READING RM 1 MINI LAB		FACULTY OFFICE DEPARTMENT COLOR
	ADMIN / GUID / CONF / HEALTH		TECHNOLOGY EDUCATION 1 COMP LAB 1 CR 1 SHOP		HUMANITIES		DRAMA
	MATH 12 CR 1 COMP LAB		ART 5 STUDIOS (INCLUDING GRAPHIC ARTS) 1 COMP LAB		SPECIAL EDUCATION 1 CR 3 TUTORIALS		PHYSICAL EDUCATION
	FOREIGN LANGUAGES 12 CR 1 LANG LAB		MUSIC 1 BAND / ORCHESTRA 2 CR 1 COMP LAB		SOCIAL STUDIES 12 CR 1 COMP LAB		CORE FACILITIES / MECH / TOILETS / CUST
	SCIENCE 14 LABS PREP ROOMS OFFICE		BUSINESS 7 CR 1 COMP LAB		NEW ENCLOSED LINKS		POTENTIAL CLASSROOMS

ENLARGE TEACHING STATIONS
 RELOCATE DEPARTMENTAL OFFICES TO SMALLER NON-CLASSROOM SPACES
 EACH DEPARTMENT TO SHARE CLASSROOM SPACE.
 CREATE DRAMA CENTER AT MUSIC CLASSROOM / STAGE
 CONVERT EXISTING GIRLS GYM (1950 BUILDING) TO MUSIC CENTER
 CONSTRUCT "MINI GYM" ADDITION TO FIELD HOUSE
 GIRLS LOCKER ROOM TO REMAIN IN 1950 BUILDING
 CONSTRUCT ENCLOSED ADDITION TO FIELDHOUSE

NON-HIGH SCHOOL USES TO REMAIN:
 SUPERINTENDENT'S OFFICE
 DISTRICT SPECIAL NEEDS OFFICE
 DISTRICT MAINTENANCE FACILITY
 RCTV

NON-HIGH SCHOOL USES TO BE REMOVED:
 REAP
 CHINESE CULTURAL CENTER
 SEEM COLLABORATIVE
 RISE PRESCHOOL



GROUND FLOOR PLAN

READING HIGH SCHOOL
 GROUND FLOOR PLAN

OPTION C.1

STREKALOVSKY & HORT ARCHITECTS, INC.
 31 NORTH ST. HINGHAM, MA



LEGEND - 1600 PUPIL

OTHER USES	HEALTH 2 CR	ENGLISH 12 CR 1 COMP LAB 1 READING RM 1 MINI LAB	FACULTY OFFICE DEPARTMENT COLOR
ADMIN / GUID / CONF / HEALTH	TECHNOLOGY EDUCATION 1 COMP LAB 1 CR 1 SHOP	HUMANITIES	DRAMA
MATH 12 CR 1 COMP LAB	ART 5 STUDIOS (INCLUDING GRAPHIC ARTS) 1 COMP LAB	SPECIAL EDUCATION 1 CR 3 TUTORIALS	PHYSICAL EDUCATION
FOREIGN LANGUAGES 12 CR 1 LANG LAB	MUSIC 1 BAND / ORCHESTRA 2 CR 1 COMP LAB	SOCIAL STUDIES 12 CR 1 COMP LAB	CORE FACILITIES / MECH / TOILETS / CUST
SCIENCE 14 LABS PREP ROOMS OFFICE	BUSINESS 7 CR 1 COMP LAB	NEW ENCLOSED LINKS	POTENTIAL CLASSROOMS

ENLARGE TEACHING STATIONS
 RELOCATE DEPARTMENTAL OFFICES TO SMALLER NON-CLASSROOM SPACES
 EACH DEPARTMENT TO SHARE CLASSROOM SPACE.
 CREATE DRAMA CENTER AT MUSIC CLASSROOM / STAGE
 CONVERT EXISTING GIRLS GYM (1950 BUILDING) TO MUSIC CENTER
 CONSTRUCT "MINI GYM" ADDITION TO FIELD HOUSE
 GIRLS LOCKER ROOM TO REMAIN IN 1950 BUILDING
 CONSTRUCT ENCLOSED ADDITION TO FIELDHOUSE

NON-HIGH SCHOOL USES TO REMAIN:
 SUPERINTENDENTS OFFICE
 DISTRICT SPECIAL NEEDS OFFICE
 DISTRICT MAINTENANCE FACILITY
 RCTV

NON-HIGH SCHOOL USES TO BE REMOVED:
 REAP
 CHINESE CULTURAL CENTER
 SEEM COLLABORATIVE
 RISE PRESCHOOL

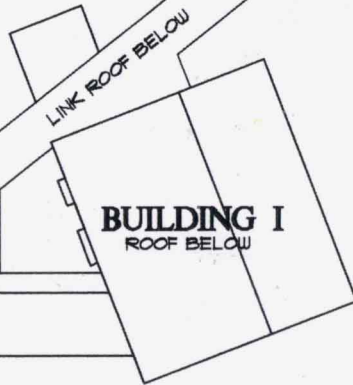
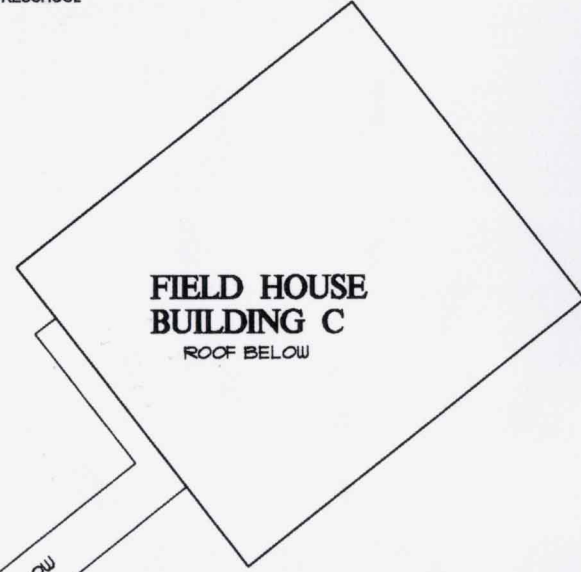
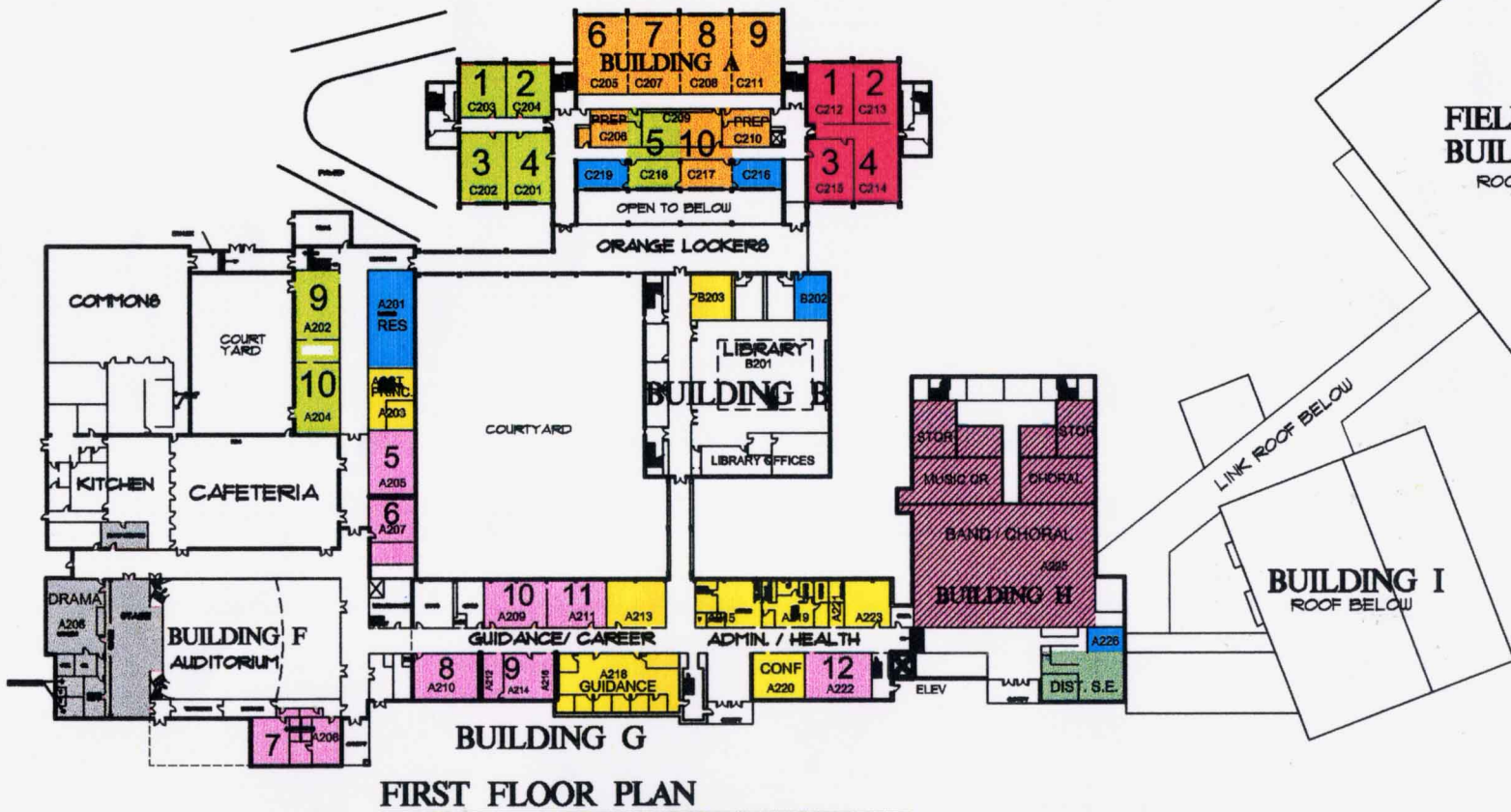

**READING HIGH SCHOOL
 FIRST FLOOR PLAN
 OPTION C.1**
 STREKALOVSKY & HOIT ARCHITECTS, INC
 31 NORTH ST. HINGHAM, MA

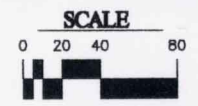

LEGEND - 1600 PUPIL

<p> OTHER USES</p> <p> ADMIN / GUID / CONF / HEALTH</p> <p> MATH 12 CR 1 COMP LAB</p> <p> FOREIGN LANGUAGES 12 CR 1 LANG LAB</p> <p> SCIENCE 14 LABS PREP ROOMS OFFICE</p>	<p> HEALTH 2 CR</p> <p> TECHNOLOGY EDUCATION 1 COMP LAB 1 CR 1 SHOP</p> <p> ART 5 STUDIOS (INCLUDING GRAPHIC ARTS) 1 COMP LAB</p> <p> MUSIC 1 BAND / ORCHESTRA 2 CR 1 COMP LAB</p> <p> BUSINESS 7 CR 1 COMP LAB</p>	<p> ENGLISH 12 CR 1 COMP LAB 1 READING RM 1 MINI LAB</p> <p> HUMANITIES</p> <p> SPECIAL EDUCATION 1 CR 3 TUTORIALS</p> <p> SOCIAL STUDIES 12 CR 1 COMP LAB</p> <p> NEW ENCLOSED LINKS</p>	<p> FACULTY OFFICE DEPARTMENT COLOR</p> <p> DRAMA</p> <p> PHYSICAL EDUCATION</p> <p> CORE FACILITIES / MECH / TOILETS / CUST</p> <p> POTENTIAL CLASSROOMS</p>
--	---	---	--

ENLARGE TEACHING STATIONS
 RELOCATE DEPARTMENTAL OFFICES TO SMALLER NON-CLASSROOM SPACES
 EACH DEPARTMENT TO SHARE CLASSROOM SPACE.
 CREATE DRAMA CENTER AT MUSIC CLASSROOM / STAGE
 CONVERT EXISTING GIRLS GYM (1950 BUILDING) TO MUSIC CENTER
 CONSTRUCT "MINI GYM" ADDITION TO FIELD HOUSE
 GIRLS LOCKER ROOM TO REMAIN IN 1950 BUILDING
 CONSTRUCT ENCLOSED ADDITION TO FIELDHOUSE

NON-HIGH SCHOOL USES TO REMAIN:
 SUPERINTENDENT'S OFFICE
 DISTRICT SPECIAL NEEDS OFFICE
 DISTRICT MAINTENANCE FACILITY
 RCTV

NON-HIGH SCHOOL USES TO BE REMOVED:
 REAP
 CHINESE CULTURAL CENTER
 SEEM COLLABORATIVE
 RISE PRESCHOOL

