



READING PUBLIC SCHOOLS

Harry K. Harutunian, Ph. D
Superintendent

KILLAM ELEMENTARY SCHOOL

333 Charles Street
Reading, Massachusetts 01867
Paul A. Guerrette, Principal

TO: Dr. Harry Harutunian
FROM: Paul A. Guerrette
RE: Killam School Wiring Plan
DATE: January 8, 1998

781-944-7831
781-942-9186 (Fax)

The following is the planned numbers of drops/connections required for the J. W. Killam School based on the "List of Requirements for Wiring Reading Schools - Version 1.0" prepared by members of Reading Schools' Technology Committee.

1. 24 classrooms - each having 5 connections for data, 1 connection for voice, and 1 connection for video
2. OFFICE AREA CONFIGURATIONS:
 - a. Main Office 4 data connections
2 voice connections
 - b. Nurse's Office 2 data connections
1 voice connection
 - c. Principal's Office 2 data connections
1 voice connection
 - d. Back Conference Room 2 data connections
1 voice connection
 - e. Office Work Area 2 data connections
1 voice connection
 - f. Counselor/Psychologist 2 data connections
1 voice connection
3. RESOURCE ROOMS:
 - a. 4/5 High Density area 4 data connections
2 voice connections
 - b. Speech Room 2 data connections
1 voice connection

- | | |
|--|---|
| b. Cafeteria Office | 2 data connections
1 voice connection |
| c. Teacher's Lounge | 2 data connections
1 voice connection |
| d. Teacher's Work Room | 2 data connections
1 voice connection |
| e. Gym Teacher's Office
(2 people) | 4 data connections
2 voice connections |
| f. Art Teacher's Office
in supply closet (2 people) | 4 data connections
2 voice connections |

NOTE: There are presently 10 locations that have drops (2 in media center area and one each in rooms 5-12). These should be reviewed and factored into the above needs.

PAG/pmo



READING PUBLIC SCHOOLS

Harry K. Harutunian, Ph.D.
Superintendent

KILLAM ELEMENTARY SCHOOL

333 Charles Street
Reading, Massachusetts 01867
Paul A. Guerrette, Principal

781-944-7831
781-942-9186 (Fax)

TO: Dr. Harry Harutunian
FROM: Paul A. Guerrette
RE: Additional Video Drops for Technology Wiring Plan*
DATE: January 28, 1998

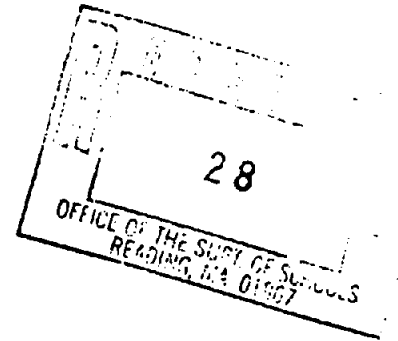

In addition to video drops in all classrooms, I would recommend drops in the following locations:

1. Cafeteria
2. Gym
3. Main corridor
4. Media Center - 3 drops

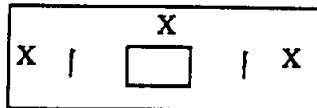

5. Principal's Office

PAG/pmo

*** CARRY THE COST OF THESE VIDEO DROPS UNDER ALTERNATE 1 AS "OPTIONAL VIDEO DROP CONNECTIONS"**

J. W. KILLAM SCHOOL
FLOOR PLAN

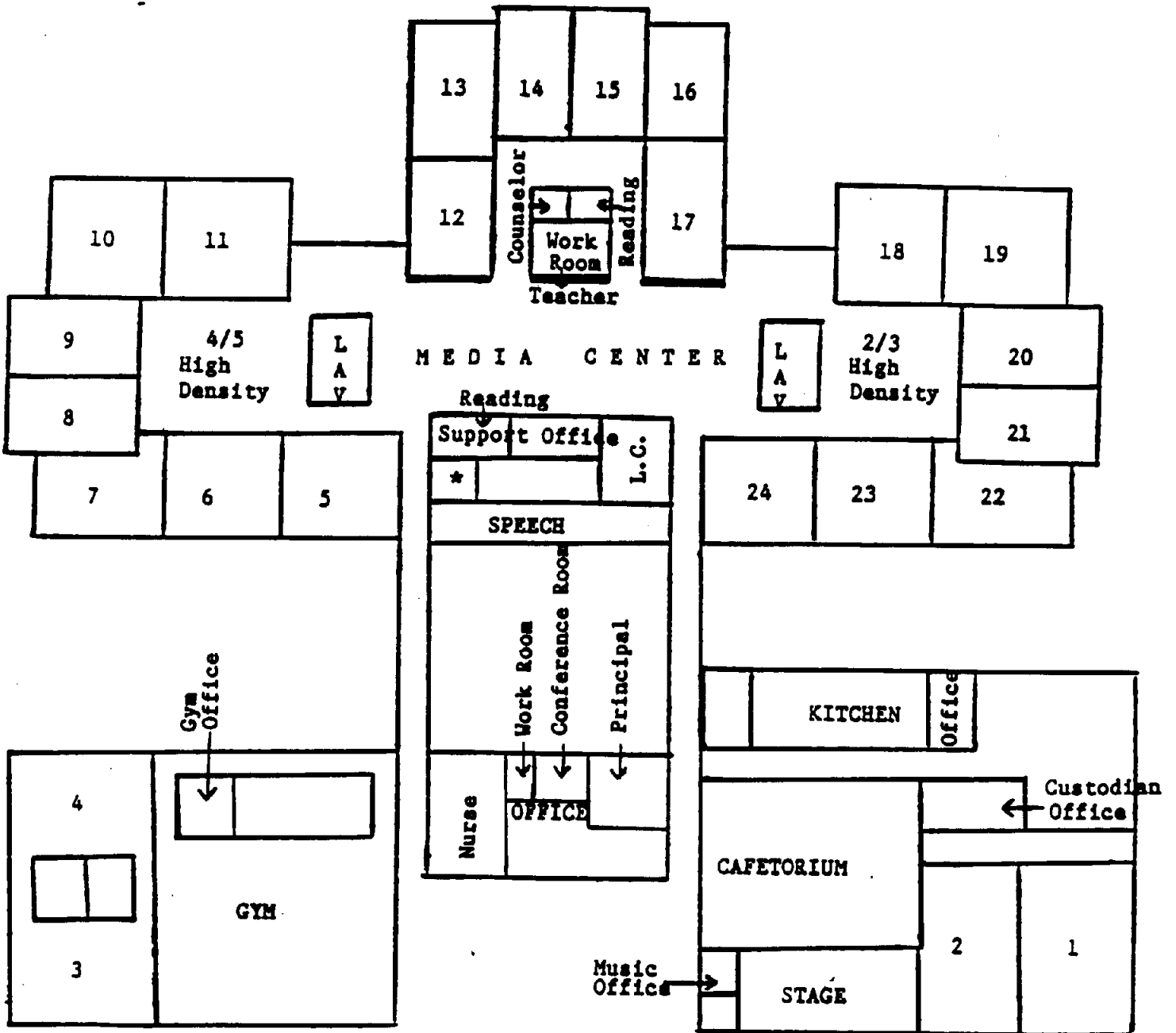

* = Location of room where LAN equipment would be located